



# C5 INDIANAPOLIS EAST

6437 Enterprise Drive, McCordsville, Indiana 46055, Hancock County

**1,236,162 SF Available Q2 2023**

[c5indianapoliseast.com](http://c5indianapoliseast.com)



LEASING AGENT



DEVELOPER

# C5 INDIANAPOLIS EAST

6437 Enterprise Way, McCordsville, Indiana 46055, Hancock County

**1,236,162 SF Available Q2 2023**

C5 Indianapolis East is located in Hancock county just two miles from I-70 and less than ten miles from I-465, the Indianapolis interstate loop that connects to all major interstates passing through Indiana. The Indianapolis International Airport and FedEx hub are within a 30-mile drive. This location allows for a strategic draw of talented workforce from Greenfield, neighboring East and South Indianapolis. This building offers a 10 year tax abatement.

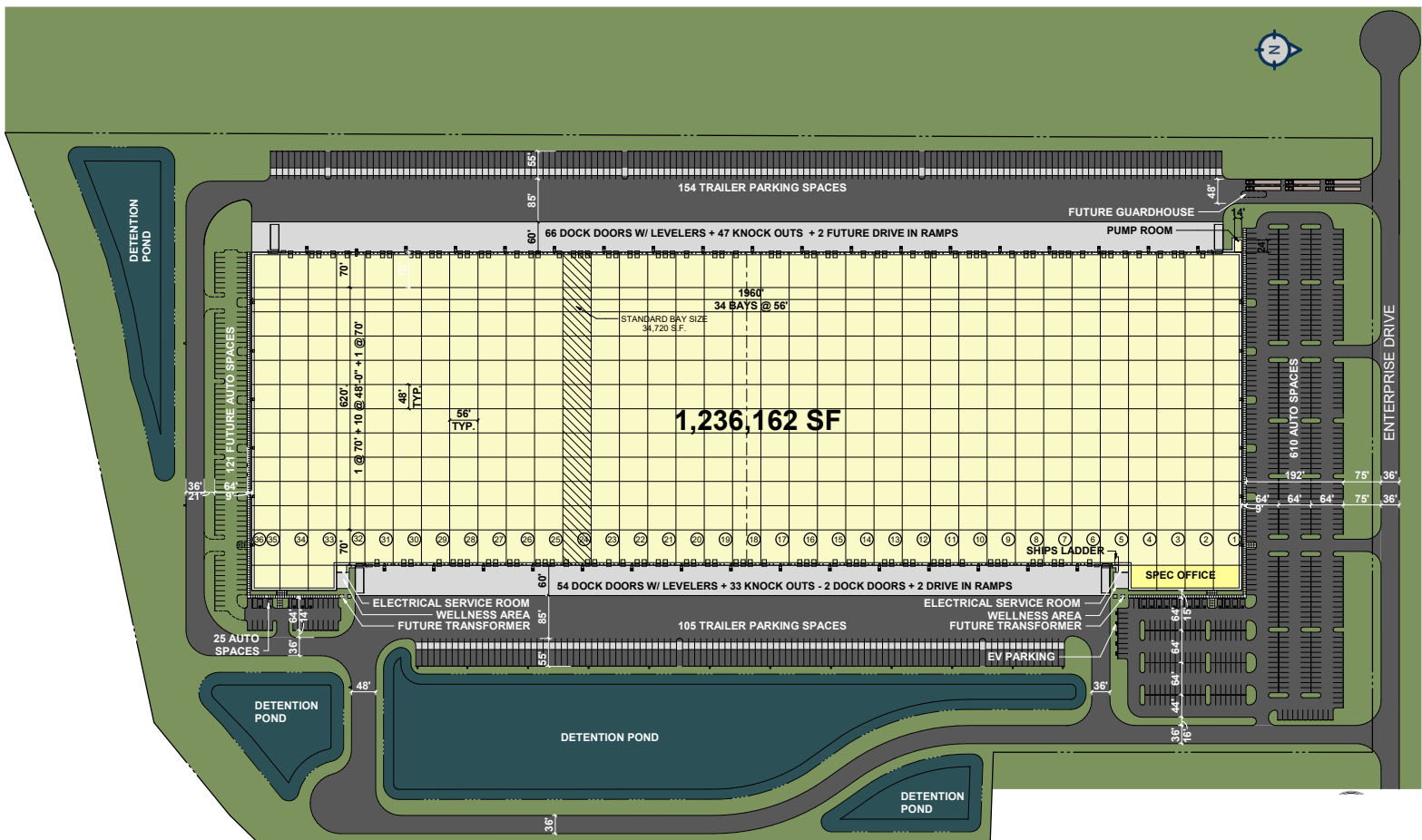

Telecom  
Nine Star  
Connect



Sewer  
Aqua Indiana



Water  
Citizens Energy  
Group



Gas  
CenterPoint  
Energy Company



Electric  
Nine Star  
Connect



Fire Department  
Buck Creek





## BUILDING SPECIFICATIONS

Square Footage	1,236,162 SF (1960' x 620')
Site Area	+/- 77.1 acres
Spec Office	11,200 SF
Configuration	Cross-dock
Column Spacing	56' wide x 48' deep, 70' deep at staging
Clear Height	40' clear minimum
Dock High Doors	120 doors w/40,000 lb air bag levelers
Drive-In Ramps	(2) 14' x 16' drive-in doors w/electric operators
Truck Court Depth	200' deep with 60' concrete apron
Auto Parking	635 spaces, 121 future spaces
Trailer Parking	259 spaces
Electrical	(2) 3,000 amp services
Sprinkler	ESFR sprinkler system w/K-25 ESFR sprinkler heads
Floor Slab	8" thick unreinforced

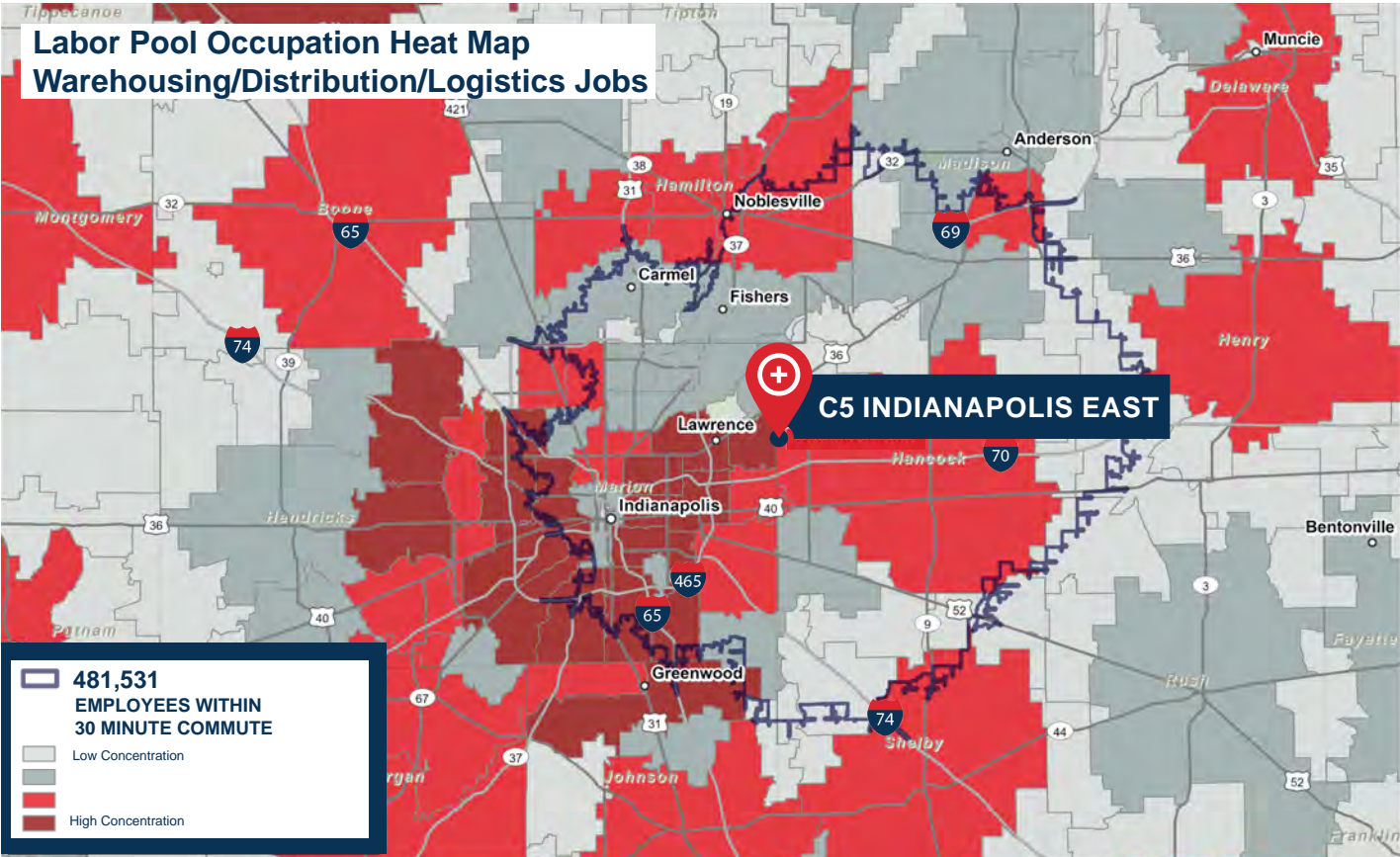

**Steve Schwegman, SIOR**  
 Sr. Managing Director  
 O 317.810.7185  
[steve.schwegman@jll.com](mailto:steve.schwegman@jll.com)

**Brian Seitz, SIOR**  
 Sr. Managing Director  
 O 317.810.7184  
[brian.seitz@jll.com](mailto:brian.seitz@jll.com)